

## CAWS Begins Planning for Next Phase of Site Development *With bridge loan paid, Phase 2 is on the horizon*

Now that we are solidly in our new home at Moraine Farm, it may seem hard to believe that a group of dedicated volunteers already is looking ahead to the next phase of site development—but they are! On December 7, the Site Committee hosted a meeting to begin to involve the community in this exciting endeavor. Some of the highlights follow:

- CAWS administrator Susan White opened the meeting by noting the school is in a period of exciting transition, abounding with new opportunities to fulfill our educational, facilities and growth aspirations. Susan noted that the school is engaged in a strategic planning process intended to strengthen all aspects of the school and to guide its growth over the next several years. (Expect to hear much more about strategic planning after the winter break.)

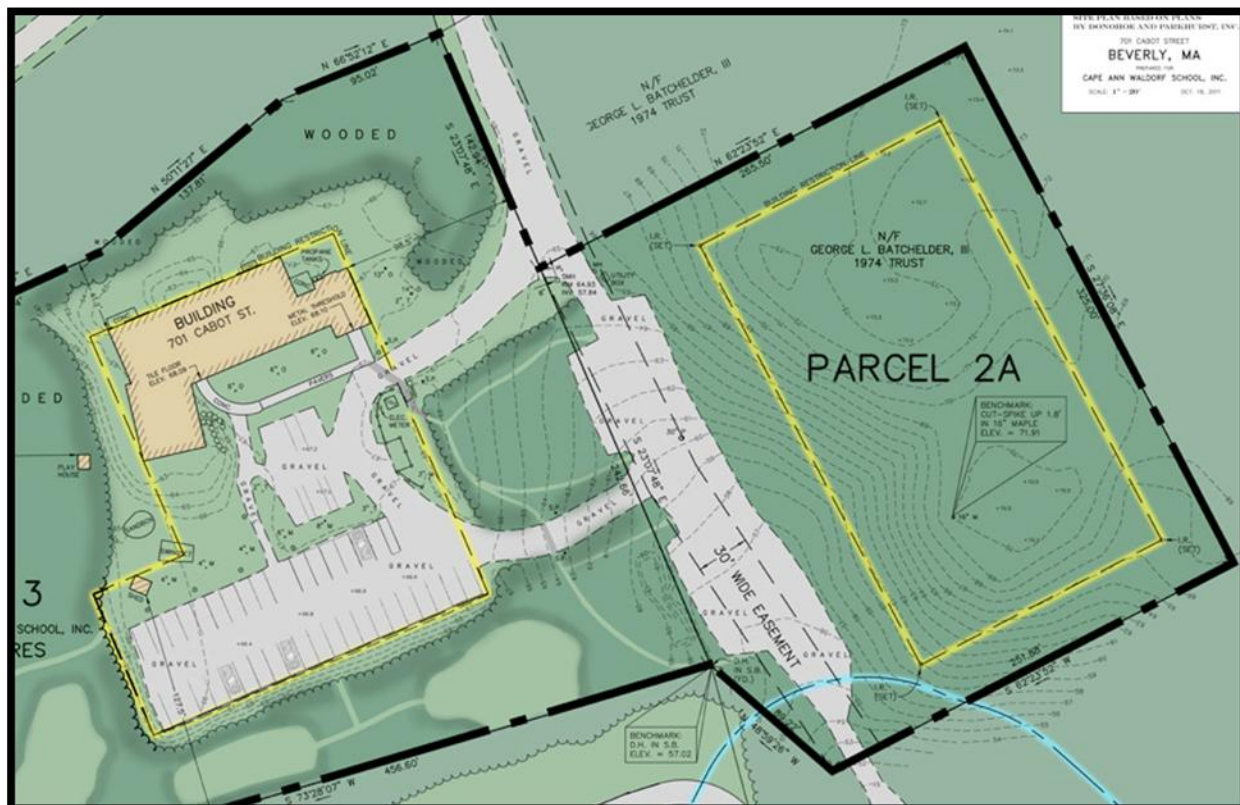

- Board member and architect Jonathan Poore explained that the move to Moraine Farm was intended to be a phased project. The objective of the first phase was simply to acquire the site and move the school onto the new property. Future phases will enhance the current property and add new buildings and facilities as the school grows.
- Jonathan reviewed the process by which the school designed the existing building addition. Much thought was given to how the next addition to the building might be integrated. For example, intentional architectural features ensure that the building can accommodate additional program space up to the square foot limits set by the conservation restriction.
- Jonathan walked the audience through a slide presentation designed to remind us of both constraints and opportunities presented by our site. He challenged us to think of the conservation “restrictions” as “stewardship responsibilities” and noted that there is adequate flexibility to meet the school’s facility needs as enrollment grows.
- Jonathan also said that CAWS leadership has already built strong and cooperative relationships with the other Moraine Farm owners. He noted how important it is to nurture these relationships and to contribute to the preservation of Moraine Farm’s scenic and historic values.
- Development consultant Lori Etringer announced that the so-called “bridge loan”—which had provisions restricting the school’s ability to raise funds for further capital improvements—has been paid in full, paving the way for future enhancements of CAWS’ campus and programming.
- Lori also noted that the school is actively preparing to acquire Parcel 2A, the two-acre plot to the east of the overflow parking lot – *see map, above*. Closing is expected to occur by the end of the calendar year. Parcel 2A comes with a second building envelope and presents exciting new opportunities for the site.

If you are interested in helping to plan for the next phase of site development, please contact Peter Rudd or Jonathan Cosco, the site committee co-chairs, or talk to any of the other members of the site committee (Laura Freysinger, Mary Mansur, Karl Pulkkinen, Eugenie Roy, Susan White, Vanya Yoors).

## **‘The Shepherds’ Play’ Shows Again Thursday Night**

*‘The Paradise Play’ Precedes it at 6:00, With Childcare for Little Ones*

These medieval plays -- the story of the birth of Jesus and the story of Adam and Eve and the fall from the Garden of Eden—are offered to the community by the faculty.

PARADISE PLAY: *Dec. 15 at 6:00 p.m. (Not appropriate for grades two and under; free childcare for young children will be available)*

SHEPHERDS’ PLAY: *Dec. 15 at 7:00 p.m.*

For more information on The Shepherds’ Play, the *Newsletter* editor recommends clicking through to this 2001 essay, [“Is Waldorf Education Christian.”](#)

## Holiday Raffle Tickets Going Fast



In four days winners will be drawn for the Enchanted Caravan's holiday raffle! Get your tickets today from Mrs. Deveau in the office – one for \$5.00, five for \$20.00. All proceeds go to the school, and this year's prizes are beautiful; look for them gracing the hallway by the office: a wool painting by Ineke van der Leeuw (*photo left by Tony Cheng*), Needle Felted Dragon Picture by Beth Crowe, Pampa Toys Waldorf Doll, \$25 gift certificate to the Enchanted Caravan.

This year, the first winner will choose from among the four items, the second winner will choose from among the remaining three items...and so on. It's a fun way to end the assembly before break. So buy your tickets...and good luck at the drawing on Friday!

---

### **Support Buddies' Food Drive: *Bring Non-Perishables Friday!!!***

The seventh grade and their second grade buddies are doing a food drive for Beverly Bootstraps. Please bring in at least one non-perishable food item to the assembly before Christmas vacation. Thank you!

## **From the Admissions and Business Offices**

### ***Re-enrollment***

All current families in Nursery, Kindergarten and Grades 1-7 will receive their re-enrollment forms by mid-January (for Early Childhood families, your agreement will reflect the class placement discussed with your child's teacher in the parent conference).

If you apply for tuition assistance by the January 10 deadline, you will receive notification of your eligibility and, if applicable, financial award by February 1.

Re-enrollment forms are due to the Business Office by February 15.

### ***Priority admissions process CAWS Siblings and Parent & Child families***

All CAWS siblings and Parent & Child families receive first priority of available spots in the Nursery, Kindergarten and Grades 1-8. The process is as follows:

- Participate in an upcoming information session/tour (see web site for event details).
- Applications due by January 23.
- All interviews and class visits scheduled.
- With an acceptance, enrollment agreement due back by February 15.
- Rolling admissions after this date.

Tuition assistance is available to eligible families whose children are ready for the 5-day Kindergarten and Grades (following the above)

*--From Kelly in Admissions and Kristen in the Business Office*

## **Renewal Magazines Easily Recycled**

All done with your free copy of *Renewal* magazine, the one sent home occasionally with the children? Please recycle your extra copies – current or past issues! – by bringing them to school and leaving them with Mrs. Deveau in the office. It's nice to have extras on hand to give away to prospective parents or for other uses. Thank you!

## **Learning Conference Coming Soon**

Keep an eye out when we return in January for more information on the WCA's annual Learning Conference. Folks are lining up the film "Race to Nowhere." A screening and discussion is expected within the last weekend in January or the first weekend in February.

## **Found at the Fair: heart pendant, dangly pearl earring**

The pendant is a small gold, swirly heart with silver garland. The earring looks like freshwater pearls, blush in color. Both can be retrieved via Pam in the office!

## **Going Soon: All Lost and Found Items!**

This week is our last chance to dig through the Lost & Found bin located downstairs next to the kitchenette. It's overflowing with fall jackets/sweatshirts and other items. Over the holiday break, leftover items will be donated.

## **Coming Soon: Community Business Directory**

*Please share your information with us*

Kindergarten parent Jocelyn Schaeffer is working with the Business Office to create an online business directory. This will help us to get to know each other and access services that we might need, all while supporting our community. Whether you are a painter, contractor, lawyer, knitter, or childcare provider, we'd like you to be part of the directory. Please fill out your business information here: <http://www.surveymonkey.com/s/WJCJ2RB>

We'll let you know when the directory is online. Your information will be posted on the CAWS web site and available for all web site visitors to see. Our goal is to have the directory online by mid-January.

## **School Delays or Cancellations**

*From our Parent Handbook, Page III-3*

Cancellations or delayed openings due to snow or bad weather will be announced on WBZ 1030 AM radio, WBZ (Channel 4, [www.wbztv.com/schoolclosings](http://www.wbztv.com/schoolclosings)), WCVB (Channel 5, [www.thebostonchannel.com](http://www.thebostonchannel.com)), and WHDH (Channel 7, [www.whdh.com](http://www.whdh.com)) television. There will be a message on the school's voice mail (978-927-8811 Ext. 10) announcing the cancellation or delay. If school is not canceled or delayed, the message will be as usual. As long as there is no loss of electricity, an email alert will be sent out notifying parents that school is cancelled or delayed.

If we have a delayed opening, it will be a two-hour delay for Kindergarten through grade eight. Doors will open at 10:00 a.m. and Main Lesson will begin at 10:10 a.m. The afternoon classes will be third and fourth periods, as usual.

When there is a delayed opening Nursery classes and Parent and Child classes will not be held.

During the day, if weather conditions worsen, school will not be called off. It is not feasible to contact all parents for early pick up. The school will remain open until the usual closing to ensure that all children are cared for. If parents wish to pick up their children early due to concerns about road conditions, they may do so at their own discretion. Student must be signed out at the office prior to leaving.

## **'Youth on the Way to Freedom,' Jan. 12 Lecture in Belmont**

"Tango on a Tightrope --Youth on the Way to Freedom," a lecture by Douglas Gerwin at the Waldorf High School in Belmont, Mass. Thursday, Jan. 12, 7:30 p.m.

The time in which a child approaches adulthood can be a tenuous one for parents and teachers alike. Douglas Gerwin outlines the distinct developmental stages of the young adolescent and

the challenges that parents and teachers face in dealing with this age group. In light of these physiological and psychological changes, the unique features of the Waldorf high school curriculum take on added significance, since they are custom designed to meet the needs of this often difficult time.

Douglas Gerwin, Ph.D., is Director of the Center for Anthroposophy – including Chair of its Waldorf High School Teacher Education Program – and Co-Director of the Research Institute for Waldorf Education. Himself a Waldorf graduate, Dr. Gerwin has taught for more than 30 years at university and high school levels in subjects ranging from biology and history to German and music. He is editor of four books related to Waldorf education as well as author of various articles on adolescence and the Waldorf curriculum. He currently resides in Amherst, Massachusetts with his wife Connie, a Waldorf high school teacher of mathematics.

Suggested donation at the door: \$10.00

## CAWS Calendar December 12, 2011 – January 7, 2012

Sunday	Monday	Tuesday	Wednesday	Thursday	Friday	Saturday
	12 3:15 Boys Basketball Practice	13 3:15 Girls Basketball Practice  5:00 Shepherds Play Practice	14	15 6:00 Paradise Play (Gr. 3 and up) Childcare provided  7:00 Shepherds Play	16 1:30 Assembly 2:40 Dismissal	17
18	19 Holiday Break	20 Holiday Break	21 Holiday Break	22 Holiday Break	23 Holiday Break	24
25	26 Holiday Break	27 Holiday Break	28 Holiday Break	29 Holiday Break	30 Holiday Break	31
1	2 School Resumes  3:15 – 5:00 Boy's Basketball Practice	3  3:15 – 5:00 Girl's Basketball Practice	4  7:00 – 8:30 7th Grade Parent Evening	5  Basketball Games Girls 3:30 Boys 4:30	6  3:15 – 5:00 Girls Basketball Practice	7